

AURA

PEPONI





Welcome to Aura, a testament to unparalleled luxury, set amidst the serene surroundings of the upscale Peponi neighborhood. The meticulously crafted 1 and 2 bedroom duplex apartments boast unique architecture complemented by a ground-floor retail hub and panoramic rooftop terrace with breathtaking views of the majestic Karura Forest.



**A SYMPHONY OF
NATURE & LUXURY**



AURA
PEPONI

THE BOTANISTS

LA CASA

AURA
EMPORIUM

FOREST GEMS

COFFEE CORNER



AMBIENT RETAIL HAVEN



Nestled away from the hustle and bustle, our carefully curated retail space with mini-market shopping, cozy cafes, health and beauty services invites you to indulge in a serene shopping experience. Tucked amidst lush greenery and refreshing breezes, its luxurious offerings guarantee a sensory delight.



ONE BEDROOM DUPLEXES



Aura's 1 bedroom duplexes transcend conventional apartment design, offering double-volume spaces in the living areas bathed in dappled light. The bedroom area is elegantly suspended over the living room, forging a breathtaking connection with the spaces below, seamlessly blending luxury with nature.





Each 2 bedroom duplex spans two levels, connected by a statement stairway that evokes the comfort of home. Enjoying elevated panoramic views, the bedrooms offer rich, bright, and airy spaces, adorned with large glazing that frames picture-perfect backdrops of the tranquil ambience.



TWO BEDROOM DUPLEXES



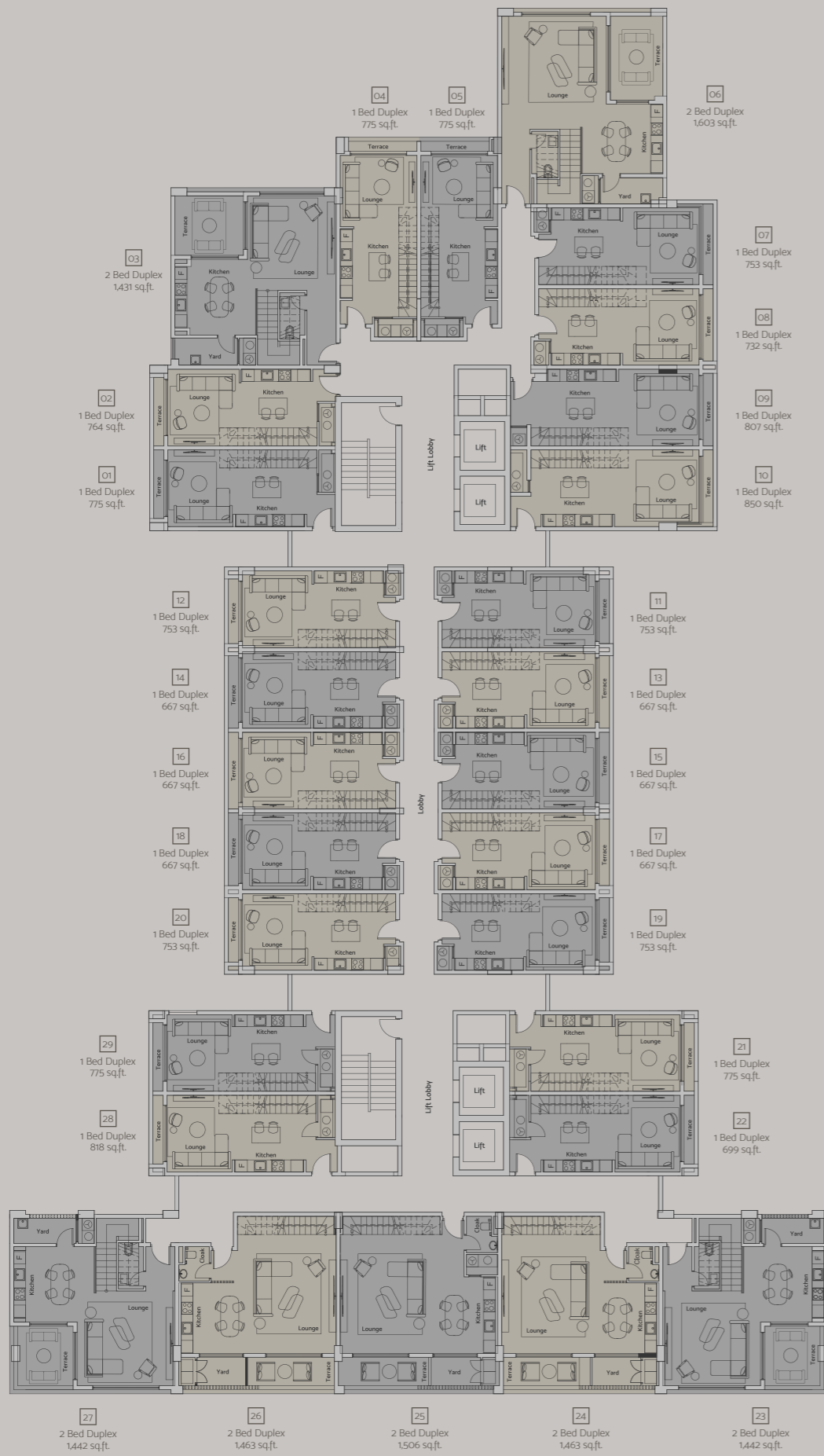

DUPLEX LOWER LEVEL LAYOUTS

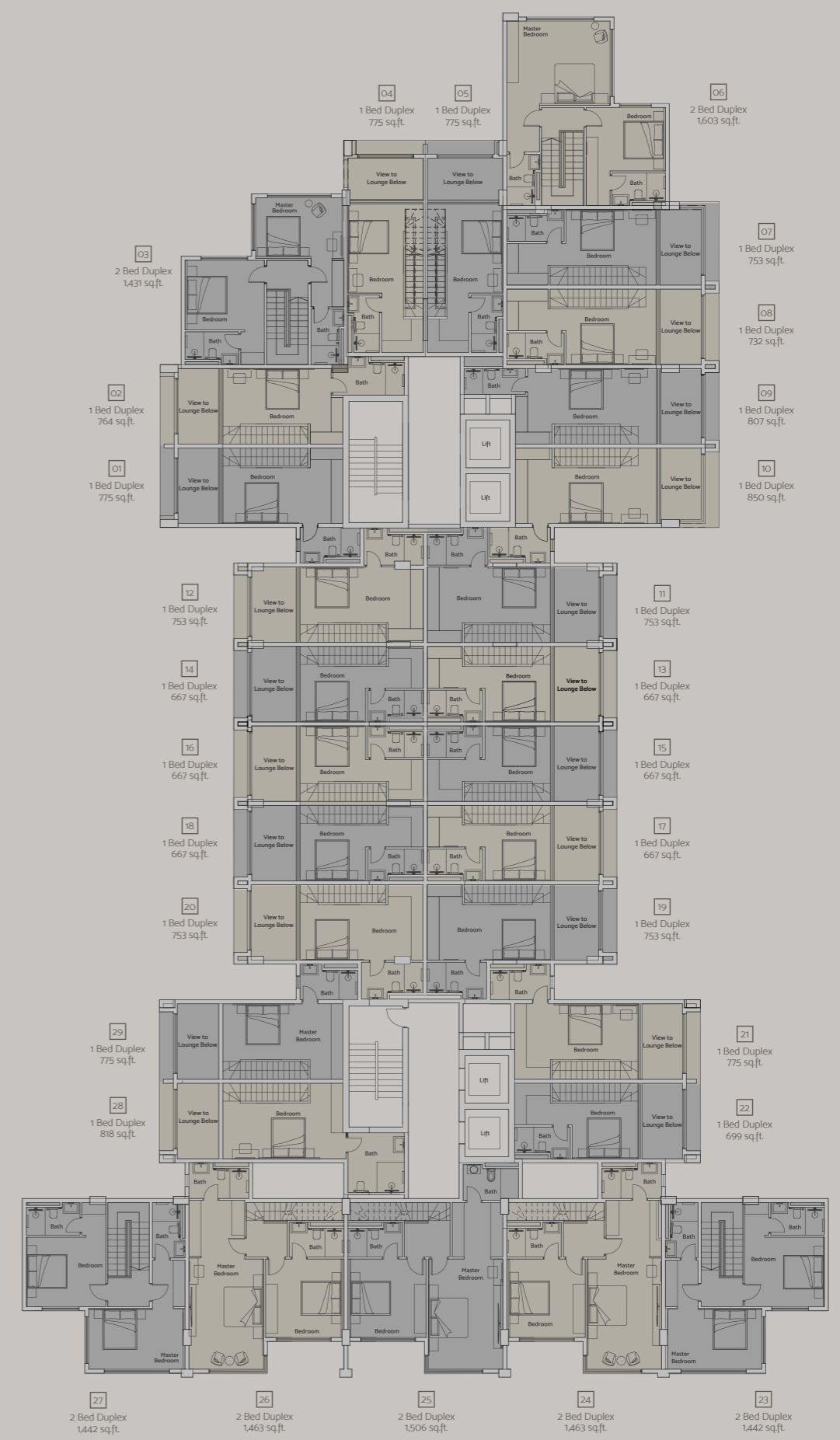

DUPLEX UPPER LEVEL LAYOUTS





THE ELEVATED ESCAPE



Overlooking lush forest vistas this rooftop oasis promises a respite from the humdrum of everyday life. With a heated rooftop pool, fully-fitted gym, residents lounge, media lounge, and inviting outdoor seating complemented by a soothing water feature, it promises an escape into serenity and leisure.



- Heated Rooftop Pool
- Residents' Lounge
- Fully Fitted Gym
- Mini Cinema
- Rooftop Outdoor Seating

- Borehole Water Supply
- Back-up Generator
- High Speed Lifts
- CCTV Surveillance
- Internet Connectivity

- SMATV
- Video Intercom
- Access Control
- Electric Fence
- Manned Security at Entrance

**ELEVATED
ELEMENTS**

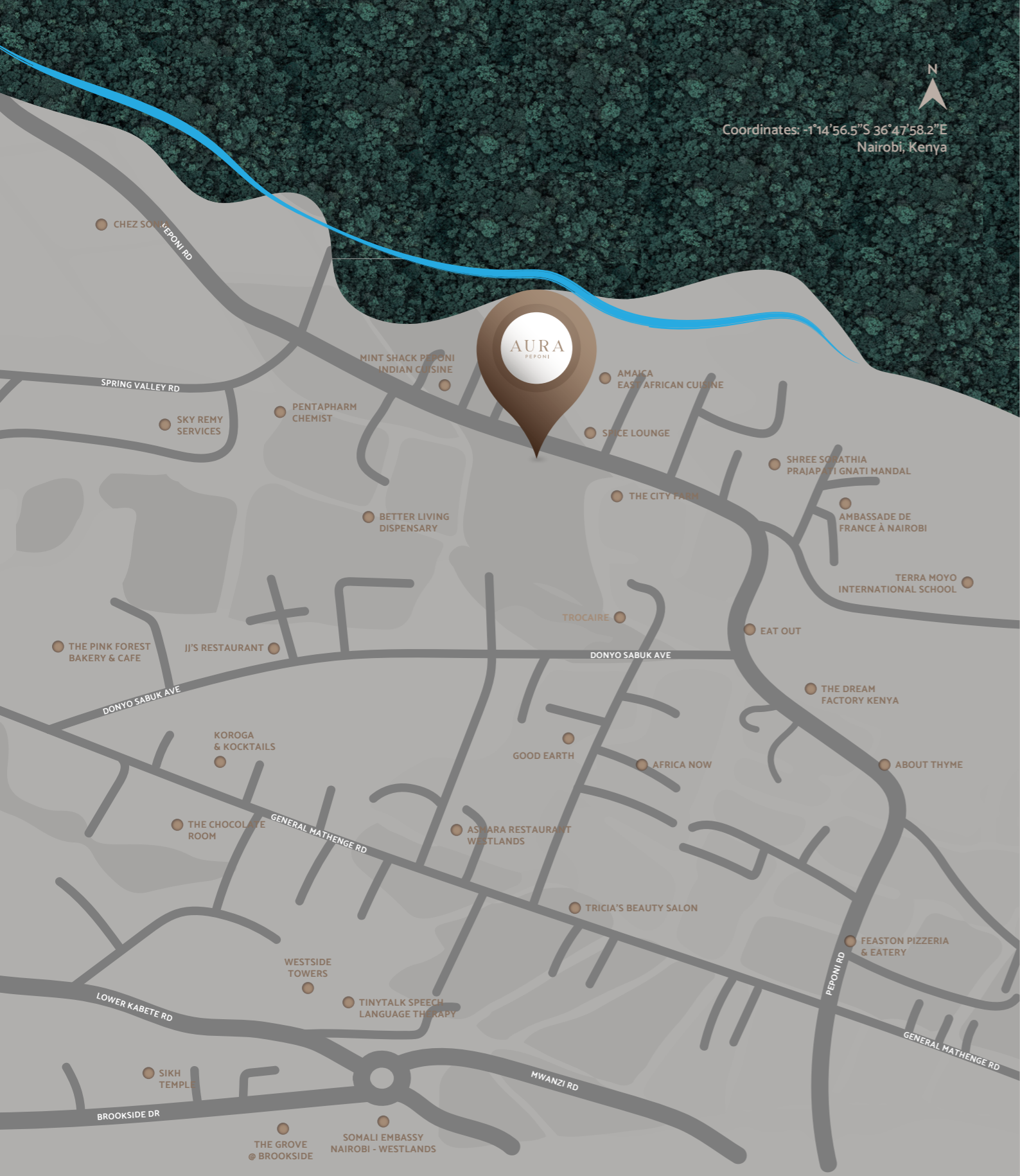

THE UNIQUE PROSPECT



Strategically positioned within the UN Blue Zone and adjacent to Westlands, Nairobi's vibrant lifestyle and commercial hub, Aura offers investors an opportunity for capital appreciation. The UN's relocation of some agencies to Kenya presents a prospect for increased demand for rental property from both local and international residents.

PROJECT TEAM

Architect

Bowman Architects

Previous Projects:

Altura, Grand Riverside, Escada,

Structural Engineer

Ngasi Consulting

Project Contractor

Canaan Developers

Service Engineer

Rex Consult

Interior Designer

Lehem Interior

Lawyers

MMA Advocates LLP

Development Consultants and Exclusive Selling Agents



HassConsult Real Estate Limited

ABC Place Waiyaki Way

P.O. Box 14090 - 00800 Nairobi Kenya

T: 0709 479 000

E: hello@hassconsult.com | W: www.hassconsult.com

Sales: 0709 479 479

Property Reference No: 2322

HassConsult Real Estate Limited for themselves and for the vendors of this property whose agents they are, give notice that these particulars do not constitute any part of an offer or a contract nor are these guaranteed to be accurate under any circumstances.

